

Domain Cabinets Direct

How to assemble a standard base cabinet

For some, cabinet assembly may seem to be a bit scary and if you haven't done it before you will probably assume that it is very complicated. However, that is not the case. The manufacturers of our cabinets are well aware of the need to speed up the installation process and, for that reason, have designed our cabinets to be easy to assemble. After all, no one can install a cabinet until it is assembled. In order to assemble a cabinet from Domain Cabinets Direct there are three easy steps to read before you start.

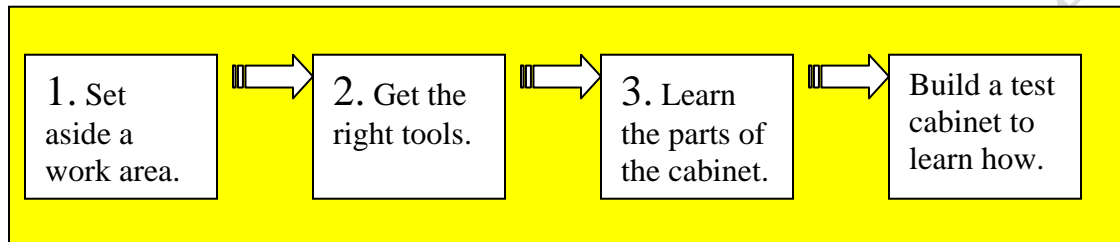

Initial Step1. First be sure you have an adequate work surface. The best surface is elevated such as a workbench. However, many choose to assemble their cabinets on the garage floor or in an area near the place that the cabinets are to be assembled. Wherever you choose, be sure that the work surface is covered with a non-marring material, such as an inexpensive piece of carpet or carpet remnant.

Initial Step2. The second step is to be sure that you have the right tools. You will need,

- a) a #2 flat and Philips screw driver
- b) a cordless screwdriver (drill motor) and bit tip holder and # 2 Phillips tips.
- c) a few clean shop rags
- d) good fitting gloves
- e) safety glasses
- f) a tape measure
- g) and a bottle of carpenter's glue



That's pretty much it. (Print and take this list with you to the hardware store). Lastly, it might be helpful to get an extra pair of hands to hold an edge or to hand you a tool. We recommend someone you get along with!

Initial Step 3. The third is to be familiar with all the cabinet parts. We recommend that you start building with a simple and small wall cabinet then move to a base cabinet. There is a very quick learning curve to building a cabinet, and if you start small you will learn the basics before going on to tackle drawers. Additionally, it is better to build one very slowly until you get good at it. So, if you have already built a few wall cabinets you are ready to move forward.

A typical base cabinet takes a pro- about 15- 45 minutes, depending on the number of drawers, to unpack and assemble. Frameless cabinets assemble much the same as framed cabinets however, with a frameless cabinet you begin with the sides and not the face frame. If it is your first one, take a little more time to assemble it and make the first one a pleasant and calm experience. We recommend that you start with a small cabinet to get familiar with the process.

Step 1. Gloves and safety glasses on.
Lay out your tools near to you (fig 1).

Step 2. Open the box, if you use a box cutter be careful not to cut into the cabinet.

Step 3. Lay out the side that will hold the door onto the non-marring work surface, this may change due to swing-out left or swing-out right (fig 2).

(fig 2)



Lay out the materials

Step 4. Place the set pins into the face frame (fig 2a). Lightly glue the contact points (fig 2b). * Note: many installation contracts eliminate the glue step. Attach sides to face frame (fig 2c and 2d).

(fig 2a)



(fig 2b)



(fig 2c)



(fig 2d)



Prepare face frame and attach sides

Box cutters can damage the wood.

Be sure to work on a non-marring surface so you won't scratch your cabinet.

Do not over tighten screws!

Remember to wipe off excess glue!

Step 5. Attach the cabinet bottom (fig 2e) and toe kick (fig 2 f).

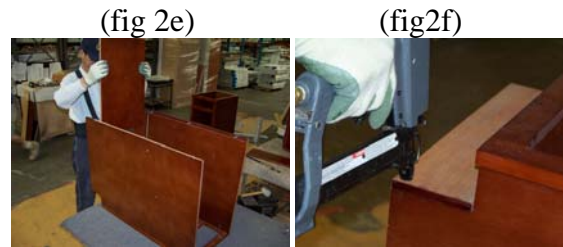

Attach bottom and toe kick

Step 6. Set cabinet back and secure all set screws and interlocks (fig 2g).



Attach cabinet back

Step 7. Glue drawer front (fig 2h). Set drawer side 1 (fig 2i). Set drawer bottom (fig 2j). Set drawer side 2 (fig 2k). Glue drawer sides at back for preparation to place drawer back (fig 2l). Place drawer back (fig 2m).

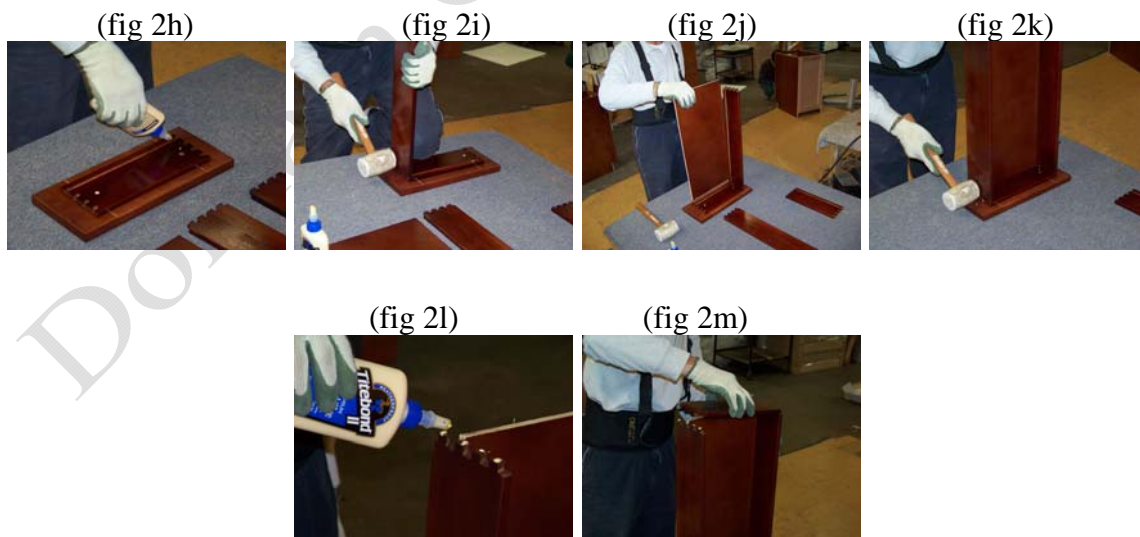

Build drawer

Step 8. Set drawer guides onto drawer (fig 2n). Set drawer glides into predrilled holes on cabinet back (fig 2o). Attach drawer guides to cabinet sides (fig 2p). Attach cabinet braces to top back of cabinet carcass fig 2q).

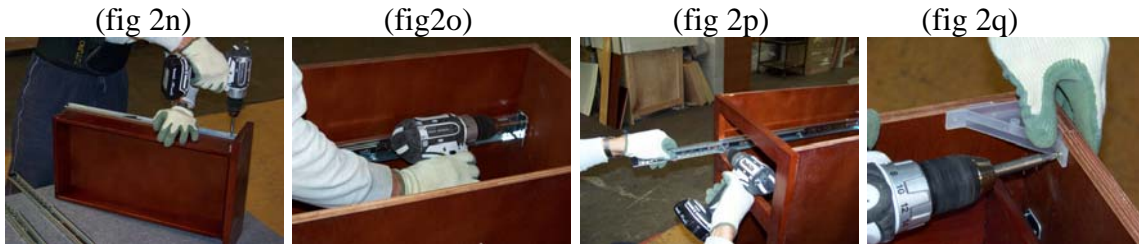

Attach finish hardware

Step 9. Set the drawer into the guides (fig 2 r). Attach cabinet door (fig 2s).

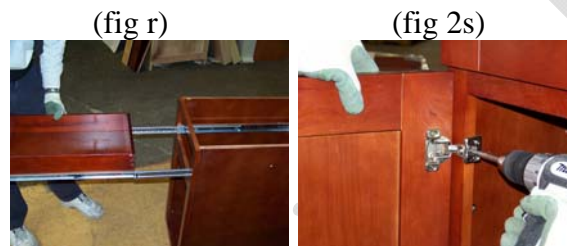

Attach finish parts



And that's it!

Whether you are building a wall cabinet, base cabinet, or pantry the procedure is much the same. We recommend that you put a few more base cabinets together before moving onto a lazy Susan or pantry. Remember be safe, slow, and clean! We hope you have a fun time assembling your RTA cabinets.