

Domain Cabinets Direct

How to assemble a Frameless base cabinet

For some, cabinet assembly may seem to be a bit scary and if you haven't done it before you will probably assume that it is very complicated. However, that is not the case. The manufacturers of our cabinets are well aware of the need to speed up the installation process and, for that reason, have designed our cabinets to be easy to assemble. After all, no one can install a cabinet until it is assembled. In order to assemble a cabinet from Domain Cabinets Direct there are three easy steps to read before you start.

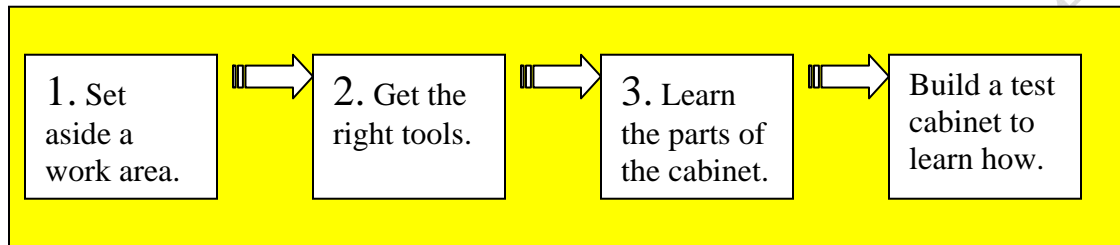

Initial Step1. First be sure you have an adequate work surface. The best surface is elevated such as a workbench. However, many choose to assemble their cabinets on the garage floor or in an area near the place that the cabinets are to be assembled. Wherever you choose, be sure that the work surface is covered with a non-marring material, such as an inexpensive piece of carpet or carpet remnant.

Initial Step2. The second step is to be sure that you have the right tools. You will need,

- a) a #2 flat and Phillips screw driver
- b) a cordless screwdriver (drill motor) and bit tip holder and # 2 Phillips tips.
- c) a few clean shop rags
- d) good fitting gloves
- e) safety glasses
- f) a tape measure
- g) and a bottle of carpenter's glue



That's pretty much it. (Print and take this list with you to the hardware store). Lastly, it might be helpful to get an extra pair of hands to hold an edge or to hand you a tool. We recommend someone you get along with!

Initial Step 3. The third is to be familiar with all the cabinet parts. We recommend that you start building with a simple and small wall cabinet then move to a base cabinet. There is a very quick learning curve to building a cabinet, and if you start small you will learn the basics before going on to tackle drawers. Additionally, it is better to build one very slowly until you get good at it. So, if you have already built a few wall cabinets you are ready to move forward.

A typical base cabinet takes a pro- about 15- 45 minutes, depending on the number of drawers, to unpack and assemble. Frameless cabinets assemble much the same as framed cabinets however, with a frameless cabinet you begin with the sides and not the face frame. If it is your first one, take a little more time to assemble it and make the first one a pleasant and calm experience. We recommend that you start with a small cabinet to get familiar with the process.

Step 1. Gloves and safety glasses on.
Lay out your tools near to you (fig 1).

Box cutters can damage the wood.

Step 2. Open the box, if you use a box cutter be careful not to cut into the cabinet.

Be sure to work on a non-marring surface so you won't scratch your cabinet.

Step 3. Lay out the side that will hold the door onto the non-marring work surface, this may change due to swing-out left or swing-out right (fig 2).

(fig 2)



Lay out the materials

Step 4. Set the drawer guide and the hinges (fig 2a, fig 2b, and fig 2c).
Set the drawer guide onto side 2 (fig 2d).

Do not over tighten screws!

(fig 2a)



(fig 2b)



(fig 2c)



(fig 2d)



Set internal hardware

Step 5. Attach the toe kick to side 1 (fig 2e). Then attach side 2 onto toe kick (fig 2f).

(fig 2e)



(fig 2f)



Attach both sides to the toe kick

Step 6. Preset all screws into side 2 (fig 2g). Screw both front internal supports into side 2 and into side 1(fig 2h).



Set screws into side 2 and attach internal supports

Step 7. Lay the cabinet on its side and slide the cabinet bottom into place (fig l). Screw both sides of the cabinet bottom into place (fig 2j and fig 2 k).

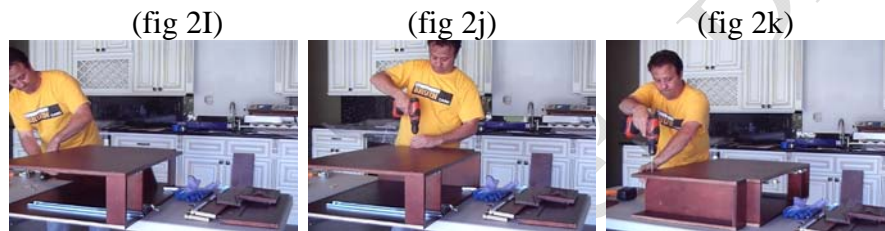

Attach cabinet bottom

Step 8. Slide the back into place and apply the internal support/cap (fig 2L and fig 2m).



Attach cabinet back

Step 9. Set the base aside and start the drawer. Place the drawer's sides down and secure them to the drawer back (fig 2n and 2o). Slide the drawer bottom into place (2p).

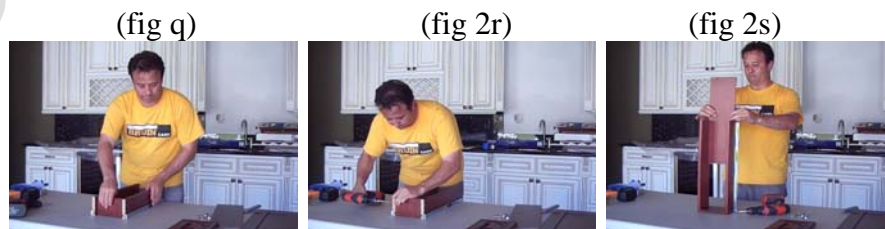

Build drawer sides and bottom

Step 10. Place the drawer front and then set it with the screws (fig 2t and 2u)

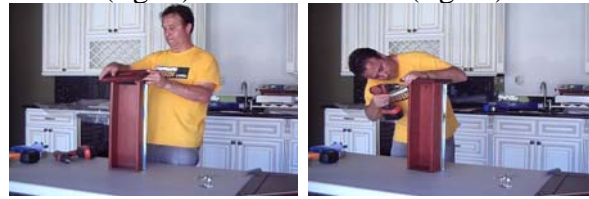

Attach drawer front

Step 11. Set the door (fig 2v). Set the shelf supports pins (fig 2w). Set the drawer and click it into the guides (fig 2x and fig 2Y).

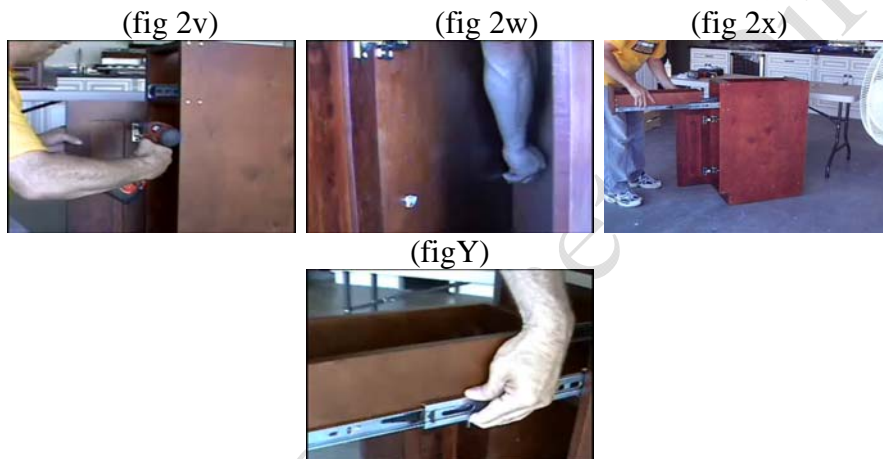

Attach finish parts

And that's it!



Whether you are building a wall cabinet, base cabinet, or pantry the procedure is much the same. We recommend that you put a few more base cabinets together before moving onto a lazy Susan or pantry. Remember be safe, slow, and clean! We hope you have a fun time assembling your RTA cabinets.